



MODEL KAWASAKI ZX-6R

YEAR 2009 - 2016

LINE FULL SYSTEM

MUFFLER SPEED EDGE

SCHEMATIC

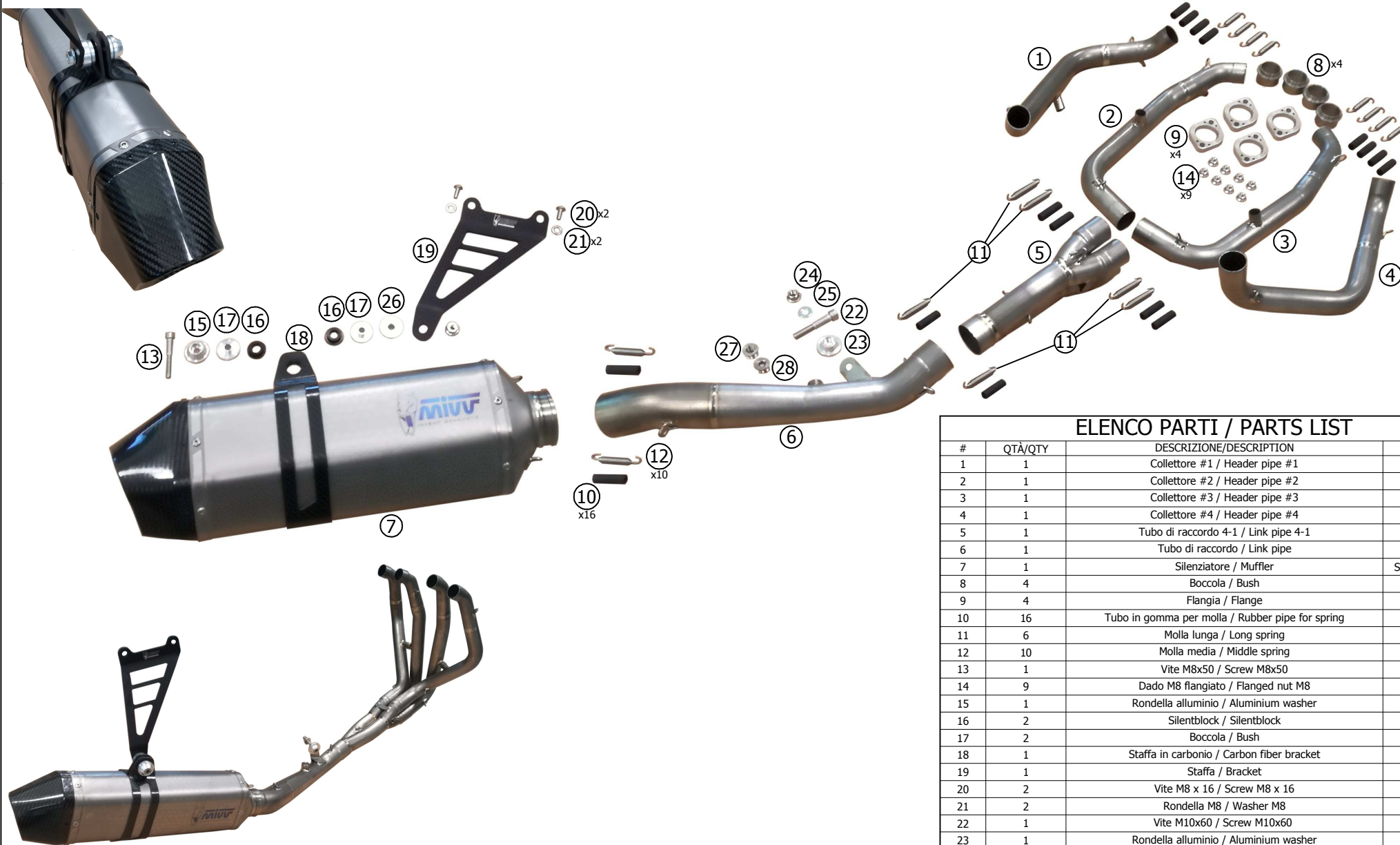

ELENCO PARTI / PARTS LIST

#	QTÀ/QTY	DESCRIZIONE/DESCRIPTION	CODICE/CODE
1	1	Collettore #1 / Header pipe #1	
2	1	Collettore #2 / Header pipe #2	
3	1	Collettore #3 / Header pipe #3	
4	1	Collettore #4 / Header pipe #4	
5	1	Tubo di raccordo 4-1 / Link pipe 4-1	
6	1	Tubo di raccordo / Link pipe	
7	1	Silenziatore / Muffler	SPEED EDGE 400
8	4	Boccola / Bush	50.73.445.1
9	4	Flangia / Flange	50.73.448.1
10	16	Tubo in gomma per molla / Rubber pipe for spring	50.73.210.1
11	6	Molla lunga / Long spring	50.71.080.1
12	10	Molla media / Middle spring	50.73.359.1
13	1	Vite M8x50 / Screw M8x50	50.73.074.1
14	9	Dado M8 flangiato / Flanged nut M8	50.73.393.1
15	1	Rondella alluminio / Aluminium washer	50.73.291.1
16	2	Silentblock / Silentblock	50.73.380.1
17	2	Boccola / Bush	50.73.381.1
18	1	Staffa in carbonio / Carbon fiber bracket	50.SS.814.1
19	1	Staffa / Bracket	50.SS.631.0
20	2	Vite M8 x 16 / Screw M8 x 16	50.73.098.1
21	2	Rondella M8 / Washer M8	50.73.270.1
22	1	Vite M10x60 / Screw M10x60	50.73.135.1
23	1	Rondella alluminio / Aluminium washer	50.73.120.1
24	1	Dado M10 flangiato / Flanged nut M10	50.73.332.1
25	1	Rondella M10 / Washer M10	50.73.013.1
26	1	Distanziale in alluminio / Aluminium spacer (Øe.30 Øi.8,5 h.10)	50.SS.645.1
27	1	Riduttore sonda lambda / Lambda probe reduction	50.73.340.1
28	1	Tappo per sonda lambda / Stopper for lambda probe	50.73.198.1

APPLICAZIONI / APPLICATIONS

CODICE / CODE	SILENZIATORE / MUFFLER	TUBO / PIPE	FASCETTA / CLAMP
00.X.KA.0001.SRX	INOX (COPPE CARBONIO) / ST. STEEL (CARBON CAPS)	INOX / ST. STEEL	CARBONIO / CARBON FIBER
00.R.KA.0001.SRT	TITANIO (COPPE CARBONIO) / TITANIUM (CARBON CAPS)	TITANIO / TITANIUM	CARBONIO / CARBON FIBER