



KTM 690 SMC R 2020 -->

OVAL
CARBON CAP

ELENCO PARTI / PARTS LIST

#	QTÀ / QTY	DESCRIZIONE / DESCRIPTION	CODICE / CODE
1	1	Tubo di raccordo / Link pipe	9773KT023SE
2	1	Protezione in gomma / Rubber protection	50.73.041.1
3	1	Staffa / Bracket	50.SS.002.0
4	1	Vite M8x20 / Screw M8x20	50.73.894.1
5	1	Rondella in alluminio / Aluminium washer	50.73.063.1
6	1	Vite M8x50 / Screw M8x50	50.73.074.1
7	1	Rondella alluminio / Aluminium washer	50.73.291.1
8	1	Staffa / Bracket	50.SS.1253.0
9	1	Dado M8 flangiato / Flanged nut M8	50.73.393.1
10	1	Silenziatore / Muffler	OVAL CARBON CAP 400
11	1	Tappo in gomma / Rubber stopper	50.73.266.1
12	1	DB killer / DB killer	50.DK.092.0
13	1	Molla media / Mid-size spring	50.73.359.1
14	1	Gommino per molla / Rubber for spring	50.73.210.1

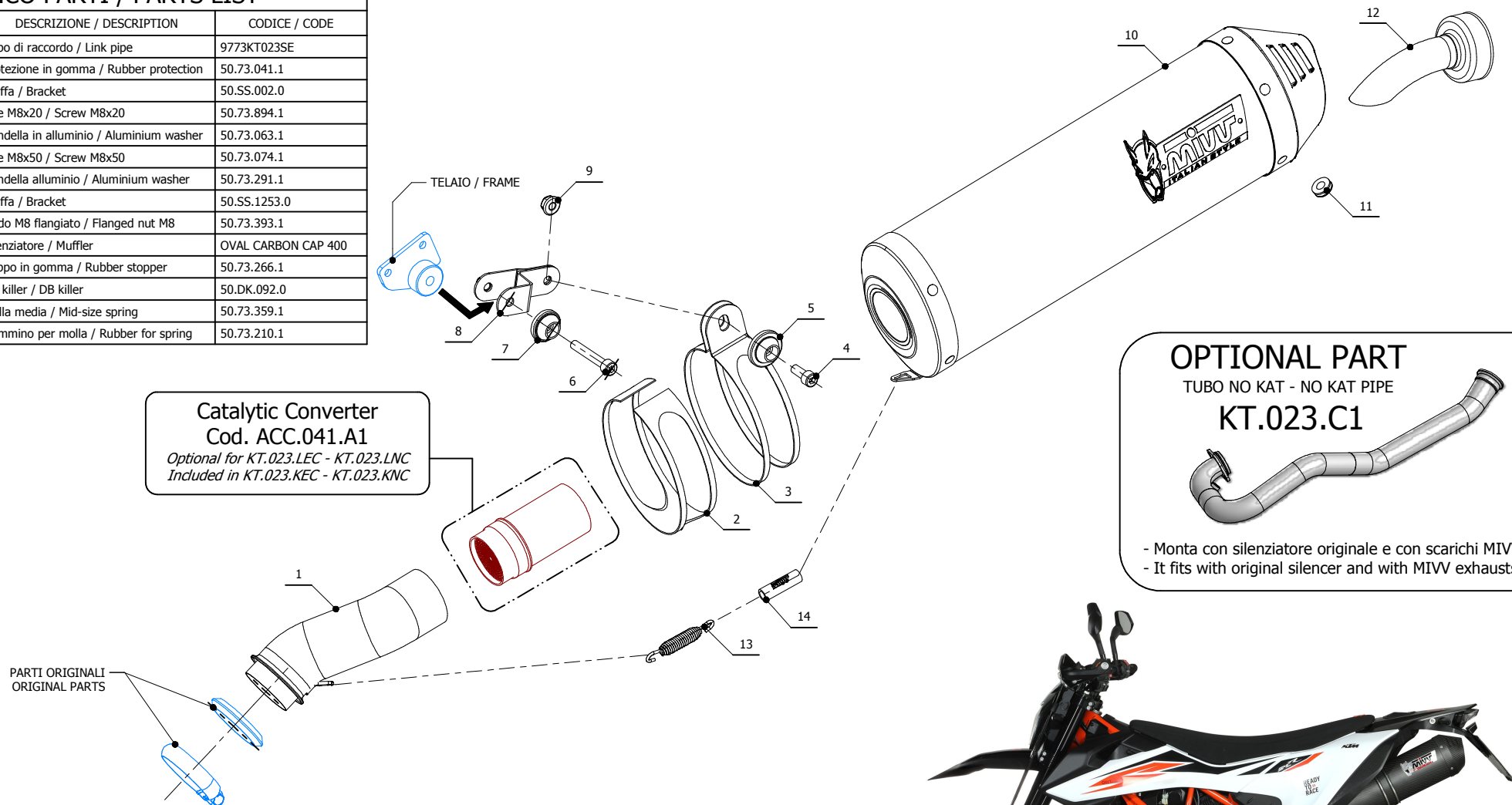

Catalytic Converter
Cod. ACC.041.A1
Optional for KT.023.LEC - KT.023.LNC
Included in KT.023.KEC - KT.023.KNC

OPTIONAL PART
TUBO NO KAT - NO KAT PIPE
KT.023.C1

- Monta con silenziatore originale e con scarichi MIVV
- It fits with original silencer and with MIVV exhausts

PARTI ORIGINALI
ORIGINAL PARTS

APPLICAZIONI / APPLICATIONS

CODICE / CODE	SILENZIATORE / MUFFLER	TUBO / PIPE	FASCETTA / CLAMP	NOTE
KT.023.LEC	CARBONIO (COPPA CARBONIO) / CARBON (CARBON CAP)	INOX / ST.STEEL	INOX / ST.STEEL	CATALYTIC CONVERTER NOT INCLUDED
KT.023.LNC	TITANIO (COPPA CARBONIO) / TITANIUM (CARBON CAP)	INOX / ST.STEEL	INOX / ST.STEEL	CATALYTIC CONVERTER NOT INCLUDED
KT.023.KEC	CARBONIO (COPPA CARBONIO) / CARBON (CARBON CAP)	INOX / ST.STEEL	INOX / ST.STEEL	CATALYTIC CONVERTER INCLUDED
KT.023.KNC	TITANIO (COPPA CARBONIO) / TITANIUM (CARBON CAP)	INOX / ST.STEEL	INOX / ST.STEEL	CATALYTIC CONVERTER INCLUDED

