



MODEL KTM RC 125

YEAR 2014-->

LINE SPORT

MUFFLER SUONO

SCHEMATIC

ELENCO PARTI / PARTS LIST

#	QTÀ / QTY	DESCRIZIONE / DESCRIPTION	CODICE / CODE
1	1	Vite M5x12 / Screw M5 x 12	50.73.628.1
2	1	DB killer / DB killer	50.DK.074.0
3	1	Tappo in gomma / Rubber stopper	50.73.266.1
4	1	Silenziatore / Muffler	SUONO 270
5	2	Tassello grande / Rubber big block	50.73.203.1
6	1	Staffa in carbonio / Carbon fiber bracket	50.SS.256.1
7	1	Vite M6 x 16 / Screw M6 x 16	50.73.175.1
8	2	Rondella M6 / Washer M6	50.72.027.1
9	1	Dado M6 autobloccante / M6 locknut	50.73.112.1
10	2	Vite M8x40 / Screw M8x40	50.73.075.1
11	1	Rondella in alluminio nera / Black aluminium washer	50.73.221.1
12	1	Distanziale in alluminio / Aluminium spacer(Øe.30 Øi.10,5 h.8)	50.SS.061.1
13	3	Dado M8 flangiato / Flanged nut M8	50.73.393.1
14	1	Staffa / Bracket	50.SS.876.0
15	1	Tubo di raccordo / Link pipe	9773KT016S7B
16	1	Silenziatore / Muffler	9873KT009S2A
17	1	Tubo di raccordo / Link pipe	9773KT009S7A
18	1	Vite M8x16 / Screw M8x16	50.73.006.1
19	1	Guarnizione in grafite / Graphite bush	50.72.38.44.28
20	1	Fascetta Ø 44/47 mm / Pipe clamp Ø 44/47 mm	50.FA.006.1
21	1	Distanziale alluminio / Aluminium spacer (Øe.20 Øi.8,5 h.14)	50.SS.058.1
22	1	Rondella in alluminio / Aluminium washer	50.73.248.1
23	2	Dado M5 / M5 nut	50.73.267.1
24	2	Rondella M5 / Washer M5	50.73.351.1
25	2	Distanziale in alluminio / Aluminium spacer (Øe.10 Øi.6 h.8)	50.73.759.1
26	2	Vite M5x30 / Screw M5x30	50.73.472.1
27	1	Copertura in alluminio / Aluminium cover	50.CR.022.0
28	1	Molla media / Middle spring	50.73.359.1
29	1	Tubo in gomma per molla / Rubber pipe for spring	50.73.210.1

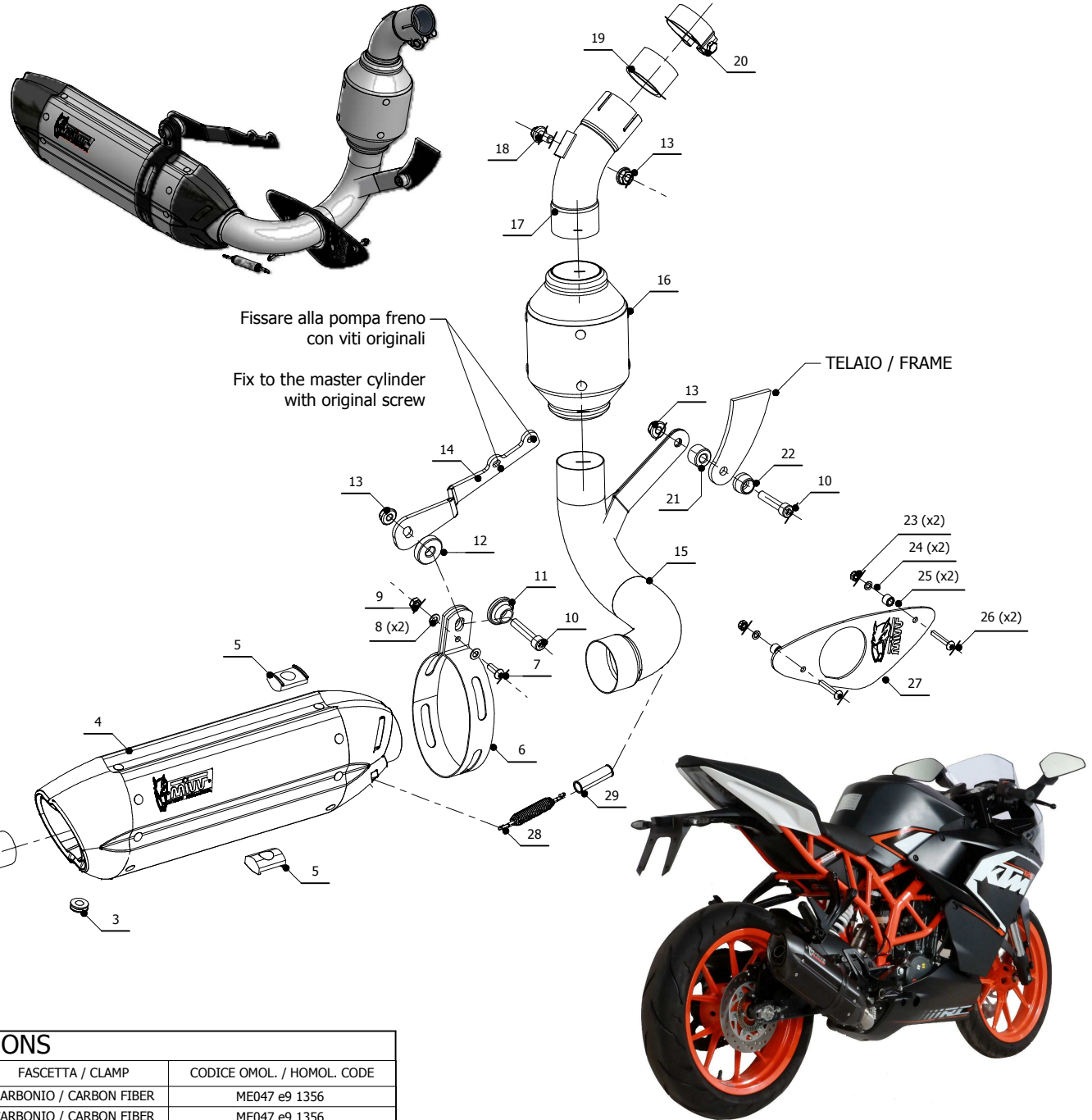

APPLICAZIONI / APPLICATIONS

CODICE / CODE	TUBO / PIPE	SILENZIATORE / MUFFLER	FASCETTA / CLAMP	CODICE OMOL. / HOMOL. CODE
KT.016.L7	INOX / ST. STEEL	INOX (COPPE CARBONIO) / ST. STEEL (CARBON CAPS)	CARBONIO / CARBON FIBER	ME047 e9 1356
KT.016.L9	INOX / ST. STEEL	STEEL BLACK	CARBONIO / CARBON FIBER	ME047 e9 1356