



MODEL HONDA CRF 250

YEAR 2008-2009

LINE STRONGER *Cross*

MUFFLER OVAL STEEL CARBON CAP

SCHEMATIC

ELENCO PARTI / PARTS LIST

#	QTÀ / QTY	DESCRIZIONE / DESCRIPTION	CODICE / CODE
1	1	DB killer / DB killer	50.DK.049.0
2	1	Rondella M6 / Washer M6	50.73.131.1
3	1	Vite M6 x 8 / Screw M6 x 8	50.72.026.1
4	1	Tappo in gomma / Rubber stopper	50.73.266.1
5	1	Silenziatore INOX / ST.STEEL muffler	OVAL CARBON CAP
6	2	Staffa / Bracket	50.73.386.1
7	4	Dado M5 autobloccante / M5 locknut	50.73.292.1
8	8	Rondella M5 / Washer M5	50.73.351.1
9	1	Staffa / Bracket	50.73.493.1
10	4	Vite M5x25 / Screw M5x25	50.73.392.1
11	3	Dado 8 MA flangiato / Flanged nut 8 MA	50.73.393.1
12	1	Staffa / Bracket	50.SS.657.0
13	3	Rondella M8 / Washer M8	50.73.270.1
14	2	Vite M8x18 / Screw M8 x 18	50.73.417.1
15	1	Distanziale in alluminio / Aluminium spacer	50.SS.454.1
16	2	Boccola in alluminio / Aluminium bush	50.73.381.1
17	2	Silentblock / Silentblock	50.73.380.1
18	1	Vite M8x50 / Screw M8 x 50	50.73.391.1
19	1	Tubo di raccordo / Link pipe	97MHO028SX1FB
20	1	Tubo di raccordo / Link pipe	97MHO028SX1FA
21	2	Fascetta con bussola / Pipe clamp with bush	50.73.466.0
22	1	Copertura in alluminio / Aluminium cover	50.CR.012.0
23	2	Vite M5 x 8 / Screw M5 x 8	50.73.459.1
24	1	Flangia / flange	50.73.385.1
25	1	Boccola / Bush	50.73.384.1
26	1	Tiramolla / Spring hook	50.73.395.1
27	5	Molla media / Middle spring	50.73.359.1
28	5	Gommino per molla / Rubber for spring	50.73.210.1

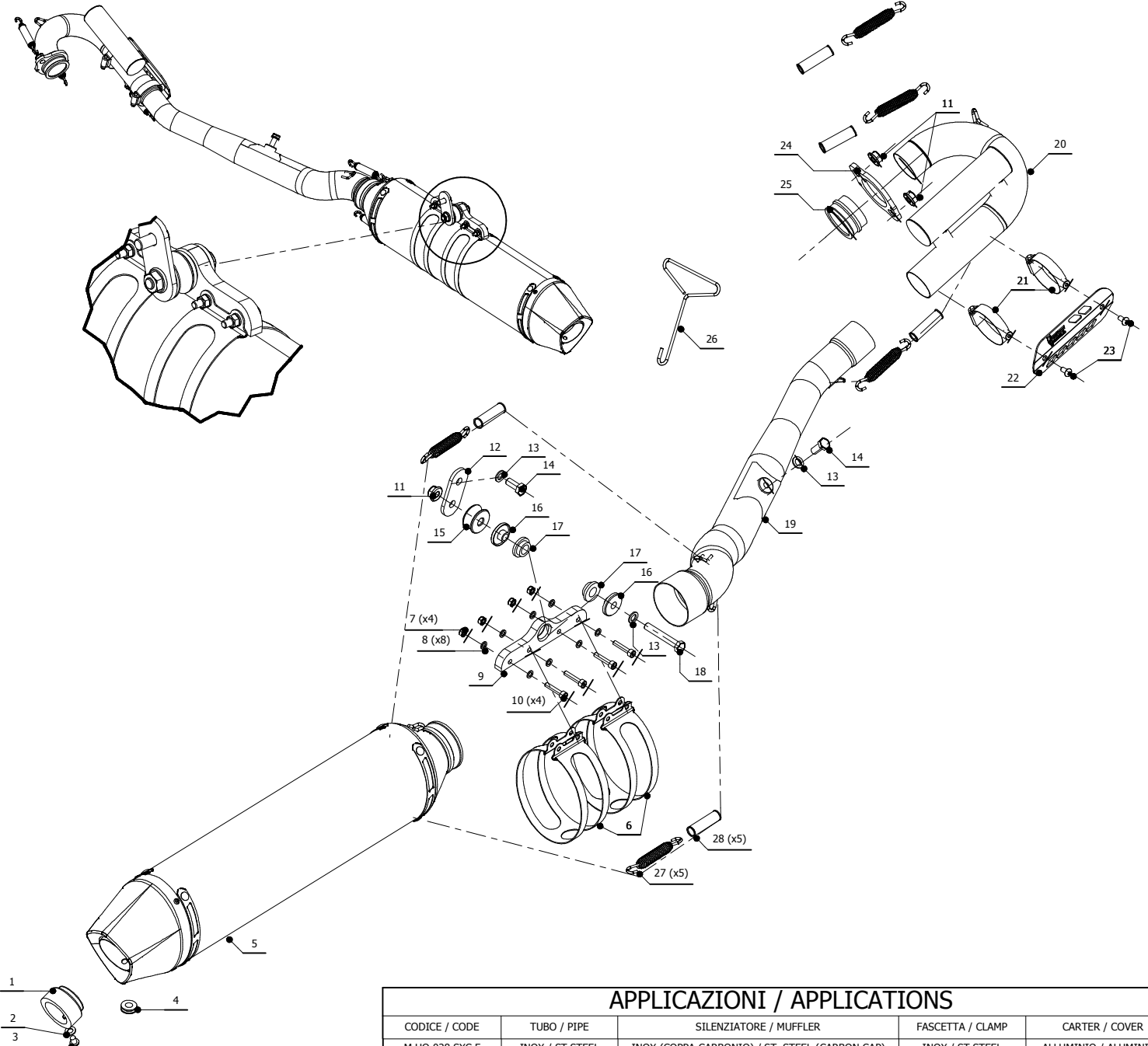

APPLICAZIONI / APPLICATIONS

CODICE / CODE	TUBO / PIPE	SILENZIATORE / MUFFLER	FASCETTA / CLAMP	CARTER / COVER
M.HO.028.SXC.F	INOX / ST.STEEL	INOX (COPPA CARBONIO) / ST. STEEL (CARBON CAP)	INOX / ST.STEEL	ALLUMINIO / ALUMINIUM