



**MODEL** KAWASAKI ZX-10R

**YEAR** 2011-2015

**LINE** FULL SYSTEM

**MUFFLER** SPEED EDGE

**SCHEMATIC**

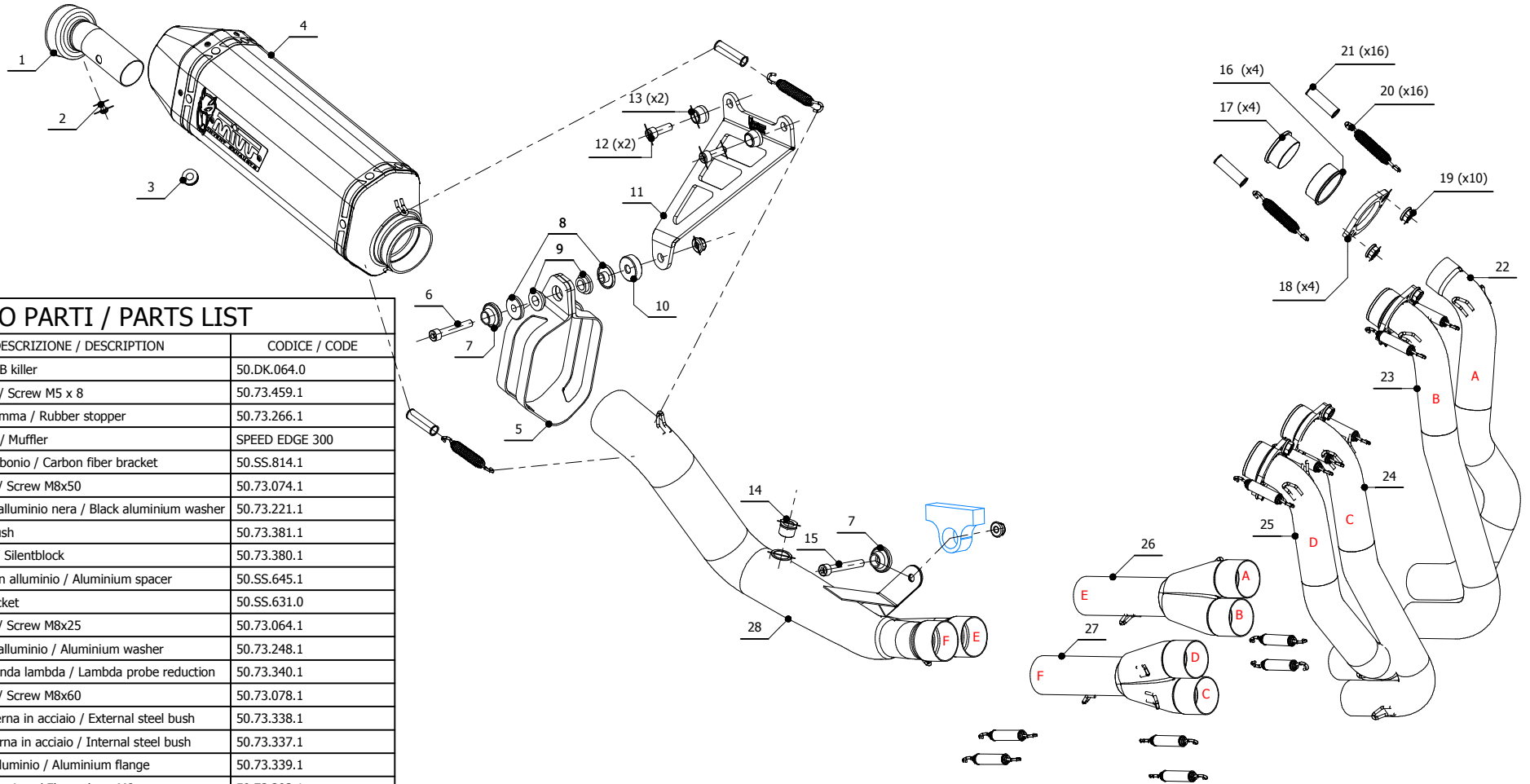

**ELENCO PARTI / PARTS LIST**

#	QTÀ / QTY	DESCRIZIONE / DESCRIPTION	CODICE / CODE
1	1	DB killer / DB killer	50.DK.064.0
2	1	Vite M5 x 8 / Screw M5 x 8	50.73.459.1
3	1	Tappo in gomma / Rubber stopper	50.73.266.1
4	1	Silenziatore / Muffler	SPEED EDGE 300
5	1	Staffa in carbonio / Carbon fiber bracket	50.SS.814.1
6	1	Vite M8x50 / Screw M8x50	50.73.074.1
7	2	Rondella in alluminio nera / Black aluminium washer	50.73.221.1
8	2	Boccola / Bush	50.73.381.1
9	2	Silentblock / Silentblock	50.73.380.1
10	1	Distanziale in alluminio / Aluminium spacer	50.SS.645.1
11	1	Staffa / Bracket	50.SS.631.0
12	2	Vite M8x25 / Screw M8x25	50.73.064.1
13	2	Rondella in alluminio / Aluminium washer	50.73.248.1
14	1	Riduttore sonda lambda / Lambda probe reduction	50.73.340.1
15	1	Vite M8x60 / Screw M8x60	50.73.078.1
16	4	Boccola esterna in acciaio / External steel bush	50.73.338.1
17	4	Boccola interna in acciaio / Internal steel bush	50.73.337.1
18	4	Flangia in alluminio / Aluminium flange	50.73.339.1
19	10	Dado M8 flangiato / Flanged nut M8	50.73.393.1
20	16	Molla media / Middle spring	50.73.359.1
21	16	Tubo in gomma per molla / Rubber pipe for spring	50.73.210.1
22	1	Collettore #1 / Header pipe #1	97XKA0005A-97RKA0005A
23	1	Collettore #2 / Header pipe #2	97XKA0005B-97RKA0005B
24	1	Collettore #3 / Header pipe #3	97XKA0005C-97RKA0005C
25	1	Collettore #4 / Header pipe #4	97XKA0005D-97RKA0005D
26	1	Tubo di raccordo 2-1 / Link pipe 2-1	97XKA0005E-97RKA0005E
27	1	Tubo di raccordo 2-1 / Link pipe 2-1	97XKA0005F-97RKA0005F
28	1	Tubo di raccordo / Link pipe	97XKA0005G-97RKA0005G

**APPLICAZIONI / APPLICATIONS**

CODICE / CODE	SILENZIATORE / MUFFLER	TUBO / PIPE	FASCETTA / CLAMP
00.X.KA.0005.SRX	INOX (COPPE CARBONIO) / ST. STEEL (CARBON CAPS)	INOX / ST. STEEL	CARBONIO / CARBON FIBER
00.R.KA.0005.SRT	TITANIO (COPPE CARBONIO) / TITANIUM (CARBON CAPS)	TITANIO / TITANIUM	CARBONIO / CARBON FIBER

