



MODEL HONDA CBR 1000 RR

YEAR 2008-->

LINE POWER EVO

MUFFLER SUONO FULL TITANIUM

SCHEMATIC

ELENCO PARTI / PARTS LIST

#	QTÀ / QTY	DESCRIZIONE / DESCRIPTION	CODICE / CODE
1	2	Tappo in gomma / Rubber stopper	50.73.266.1
2	1	Vite M5 x 8 / Screw M5 x 8	50.73.233.1
3	1	Db Killer forato / Drilled DB killer	50.DK.038.0
4	1	Silenziatore / Muffler	SUONO FT
5	2	Tassello grande / Rubber big block	50.73.203.1
6	1	Staffa in carbonio / Carbon fiber bracket	50.SS.200.1
7	1	Vite M8x50 / Screw M8x50	50.73.074.1
8	2	Rondella in alluminio nera / Black aluminium washer	50.73.221.1
9	1	Distanziale in alluminio / Aluminium spacer	50.SS.061.1
10	1	Bussola in alluminio / Aluminium bush	50.73.290.1
11	2	Dado 8 MA flangiato / Flanged nut 8 MA	50.73.052.1
12	1	Vite M8x25 / Screw M8x25	50.73.064.1
13	1	Staffa / Bracket	50.SS.569.1
14	2	Vite M6 x 12 / Screw M6 x 12	50.72.024.1
15	1	Riduttore sonda lambda / Lambda probe reduction	50.73.340.1
16	1	Tappo per sonda lambda / Stopper for lambda probe	50.73.111.1
17	1	Distanziale in alluminio / Aluminium spacer	50.SS.058.1
18	1	Rondella in alluminio / Aluminium washer	50.73.248.1
19	1	Vite M8x40 / Screw M8x40	50.73.075.1
20	3	Tubo di raccordo / Link pipe	
21	1	Tubo di raccordo 2-1 - Link pipe 2-1	
22	1	Tubo di raccordo (#1,#2) / Link pipe (#1,#2)	
23	1	Tubo di raccordo (#3,#4) / Link pipe (#3,#4)	
24	1	Collettore #1 / Down pipe #1	
25	1	Collettore #2 / Down pipe #2	
26	1	Collettore #3 / Down pipe #3	
27	1	Collettore #4 / Down pipe #4	
28	4	Flangia in alluminio / Aluminium flange	50.73.339.1
29	4	Boccola in acciaio / Steel bush	50.73.338.1
30	4	Boccola in acciaio / Steel bush	50.73.337.1
31	22	Tubo in gomma per molla / Rubber pipe for spring	50.73.210.1
32	2	Molla corta / Short Spring	50.73.123.1
33	20	Molla lunga / Long spring	50.71.080.1

DISTANZIALI CARENE / FAIRING SPACERS

#	QTÀ / QTY	DESCRIZIONE / DESCRIPTION	CODICE / CODE
1	2	Distanziale in alluminio 15mm / Aluminium spacer 15mm	50.SS.058.1
2	1	Distanziale in alluminio 20mm / Aluminium spacer 20mm	50.SS.073.1
3	2	Vite M5x30 / Screw M5x30	50.73.472.1
4	1	Vite M6x30 / Screw M6x30	50.73.471.1

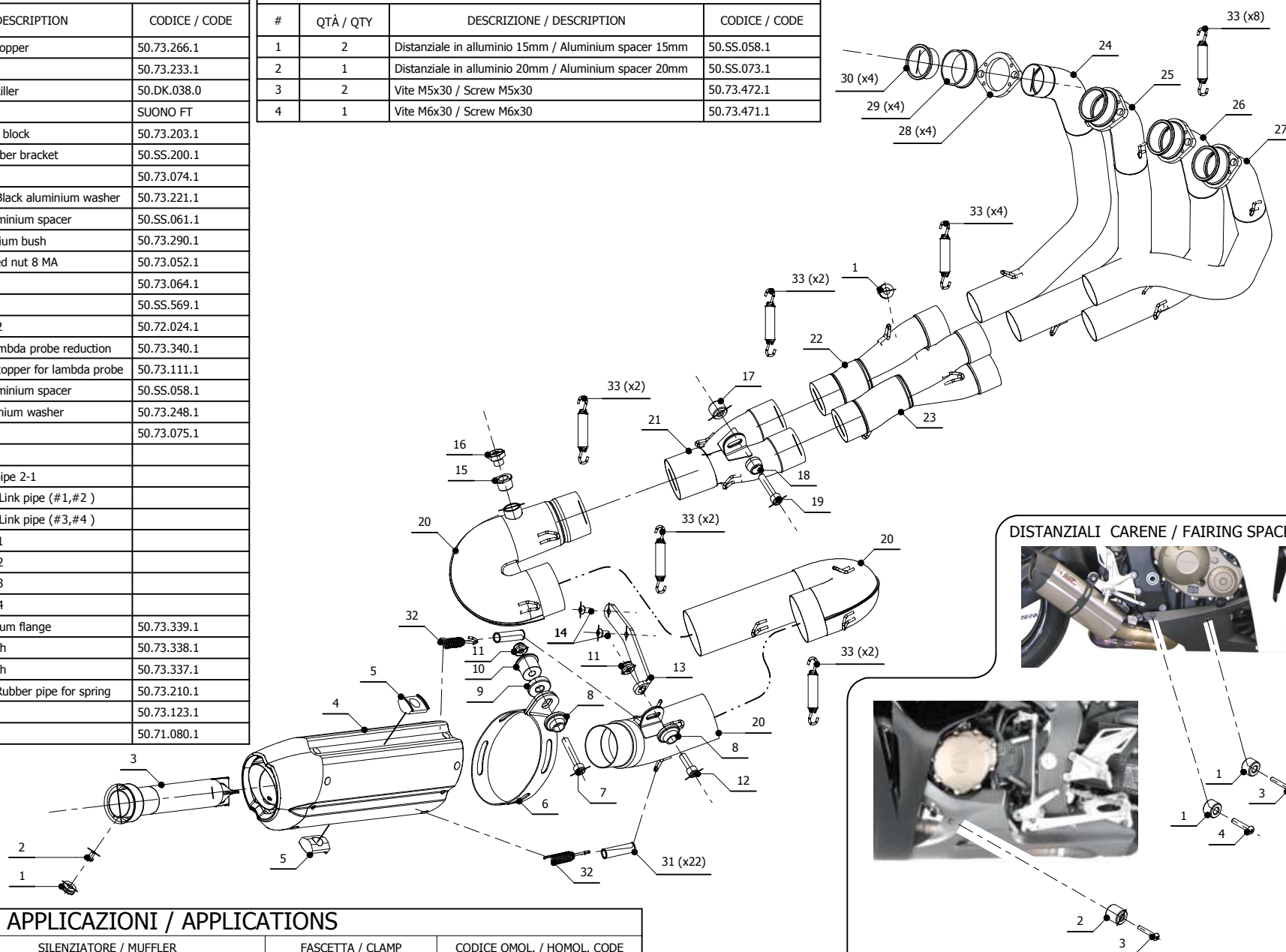

APPLICAZIONI / APPLICATIONS

CODICE / CODE	TUBO / PIPE	SILENZIATORE / MUFFLER	FASCETTA / CLAMP	CODICE OMOL. / HOMOL. CODE
00.R.HO.0002.S8	TITANIO / TITANIUM	CARBONIO E TITANIO / CARBON FIBER AND TITANIUM	CARBONIO / CARBON FIBER	